

AOT HYT 150 TON SLIP TYPE ELEVATOR

AOT #	DESCRIPTION	RANGE	SIZE OF LINKS	WT.
E39284	HYT ELEVATOR COMPLETE L/SLIPS	2 3/8" - 3 1/2"	2 1/4" - 3 1/2"	740

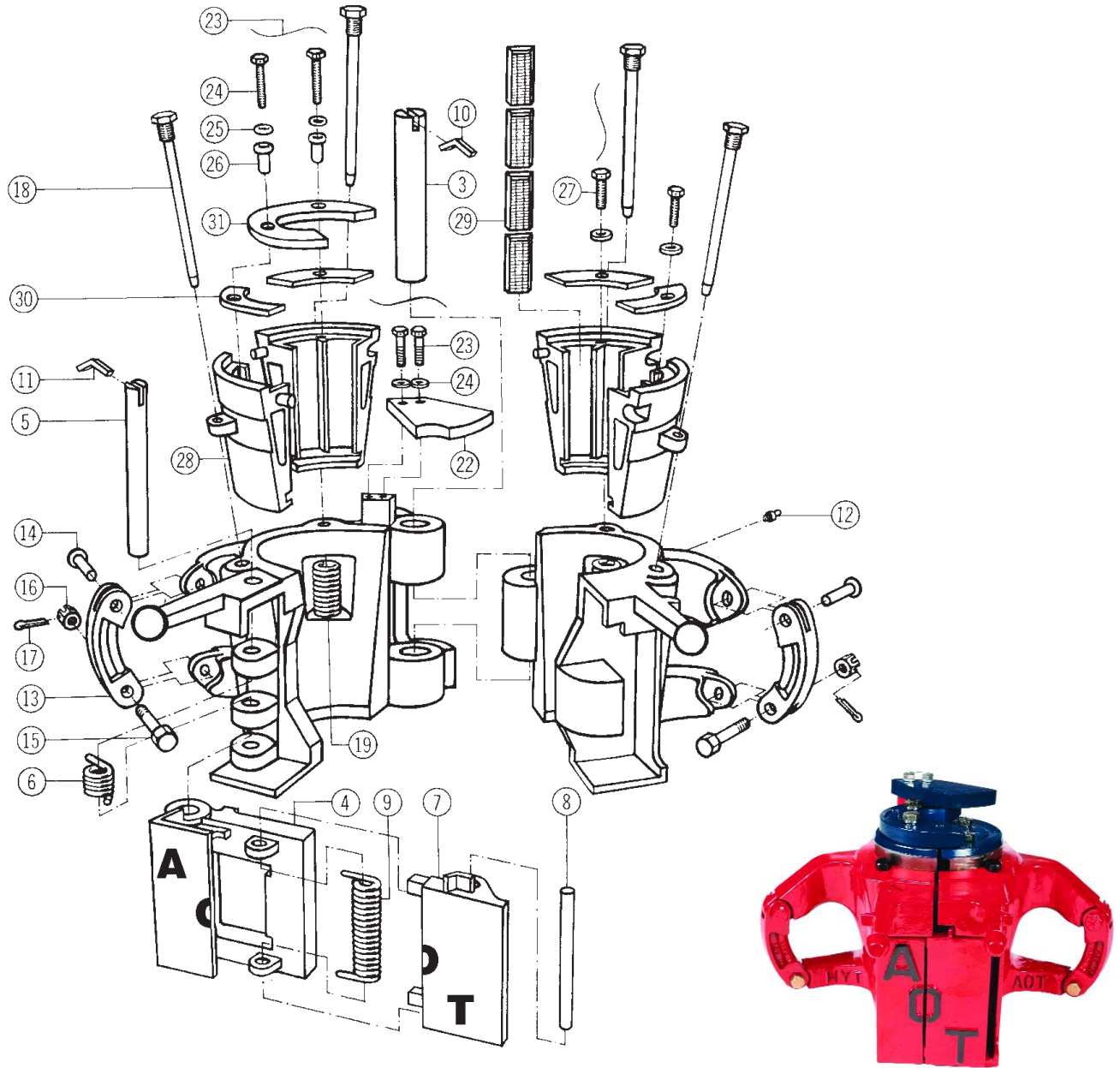

HYT SLIP ASSEMBLIES

AOT #	DESCRIPTION	WT.
E39258-2	3 1/2" X 3 1/2" HYT SLIP ASSY.	170
E39258-4	3 1/2" X 2 7/8" HYT SLIP ASSY.	170
E39259-2	2 7/8" X 2 7/8" HYT SLIP ASSY.	170
E39259-4	2 7/8" X 2 3/8" HYT SLIP ASSY.	170
E39174	3 1/2" HYT SLIP SEGMENTS ONLY (MATCHED SET OF 4)	150
E39175	2 7/8" HYT SLIP SEGMENTS ONLY (MATCHED SET OF 4)	150

HYT REPLACEMENT PARTS

AOT #	ITEM #	DESCRIPTION	**SPARES	# REQ.	WT.
E39239	3	HINGE PIN		1	12.40
E39162	4	LATCH		1	22.00
E39238	5	LATCH PIN		1	6.00
E39240	6	LATCH SPRING	2	1	.70
E39161	7	LATCH LOCK	1	1	8.00
E39251	8	LATCH LOCK PIN	1	1	.80
E39241	9	LATCH LOCK SPRING	2	1	.70
E39253	10	HINGE PIN RETAINER		1	.10
E39254	11	LATCH PIN RETAINER		1	.40
E940308-1	12	GREASE FITTING		1	.10
E9519	13	LINK BLOCK		2	5.50
E8151	14	UPPER LINK BLOCK BOLT, NUT, & COT.		2	.50
E8145	15	LINK BLOCK BOLT	2	2	.50
E8150	16	LINK BLOCK NUT	2	2	.15
E939672-19	17	COTTER PIN	2	2	.10
E52321	18	SLIP BOLT	4	4	1.00
E52539-1	19	SLIP SPRING	8	4	.80
E51090	20	GUIDE PLATE		1	8.60
E939098-65	21	GUIDE PLATE SCREW	4	2	.10
E939352-64	22	GUIDE PLATE LOCKWASHER	4	2	.10
E94787923		LOCKWIRE		A/R	.10
E939098-96	24	HEX HEAD CAPSCREW		2	.65
E939352-6	25	LOCKWASHER		4	.10
E51089	26	SETTING RING BUSHING	4	2	.15
E939098-36	27	HEX HEAD CAPSCREW	4	2	.20
E39247	30	3 1/2" & 3 1/2" X 2 7/8" INSERT RET.	8	4	.25
E39246	30	2 7/8" & 2 7/8" X 2 3/8" INSERT RET.	8	4	.25

1 YEAR SPARES, FOR 2 YEARS SPARES ADD 1 EA. OF * THESE ITEMS

HYT INSERTS

AOT #	ITEM #	DESCRIPTION	# REQ.	WT.
E24774	29	3 1/2" X 3 1/2" INSERT	32	.50
E30358	29	3 1/2" X 2 7/8" INSERT	32	.75
E24773	29	2 7/8" X 2 7/8" INSERT	16	.75
E29255	29	2 7/8" X 2 3/8" INSERT	16	1.00

RECOMMENDED SPARES INCLUDE 1 SET OF INSERTS FOR EACH PIPE SIZE TO BE RUN

HYT SETTING RINGS

AOT #	ITEM #	DESCRIPTION	# REQ.	WT.
E39214-3	31	3 1/2" HYT SETTING RING	1	11.00
E39214-2	31	2 7/8" HYT SETTING RING	1	11.00
E39214-1	31	2 3/8" HYT SETTING RING	1	13.00

RECOMMENDED SPARES INCLUDE 2 SETTING RINGS FOR EACH PIPE SIZE TO BE RUN

