

## AOT "K-70" MANUAL TONG

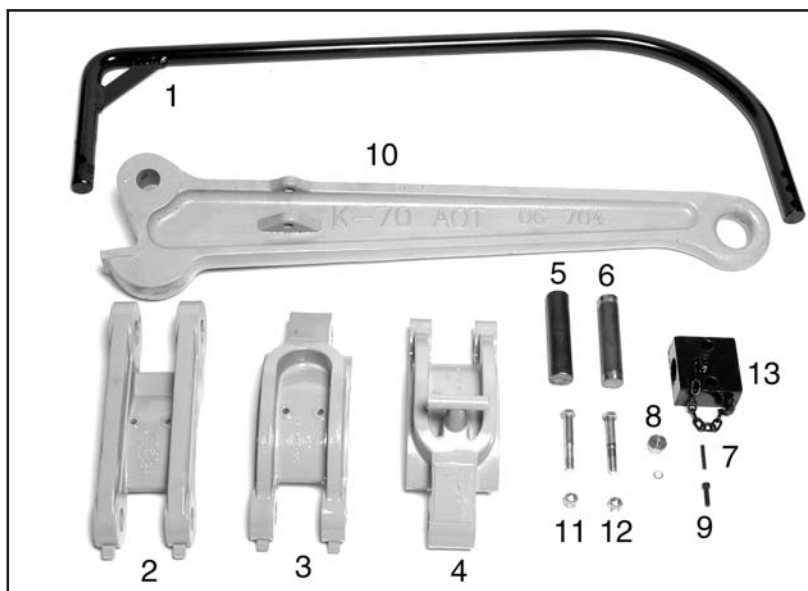

The AOT K-70 Manual Tong is designed for heavy duty service for tubing & casing. It has a size range of 3 1/2" - 7" OD with a 12,500 ft.-lb. maximum torque rating. It has a wrap-around design with approximately 300<sup>P</sup> die contact to prevent cutting or crushing of thin wall pipe. All tongs are pull tested and complete documentation is available.

AOT#	DESCRIPTION	WT.
06-701	K-70 TONG ASSY. COMPLETE LESS HANGER & DIES	82
06-702	K-70 TONG ASSY. COMPLETE LESS DIES WITH STD. HANGER	98
06-703	K-70 TONG ASSY. COMPLETE LESS DIES W/ROLLOVER HANGER	100



## REPLACEMENT PARTS FOR "K-70" MANUAL TONGS

AOT#	ITEM #	DESCRIPTION	# REQ.	WT.	*SPARES
06-704	1	K-70 TONG HANDLE	1	40.00	
06-705	2	K-70 HANDLE JAW	1	14.00	
06-706	3	K-70 CENTER JAW	1	13.00	
06-707	4	K-70 LATCH JAW	1	13.00	
06-708	5	TONG HANDLE PIN	1	.75	
06-508	6	TONG HEAD PIN	3	.50	
06-516	7	3/16" X 1 1/2" SPRING LOCK	8	.04	
06-510	8	TONG DIE BUSHING	6	.12	
06-511	9	TONG DIE SCREW	6	.06	
06-112		TONG ROLLOVER HANGER ASSY.	1	16.00	
06-113	10	TONG HANGER	1	13.00	
06-155	11	1/2" X 2 1/2" HEX HEAD CAP SCREW	1 OR 2	.15	
06-156	12	1/2" HEX NUT	1 OR 2	.08	
06-114	13	ROLLOVER BLOCK	1	2.50	
06-115		ROLLOVER LOCK PIN	1	.38	