

DRILL PIPE & CASING TONGS

Drill Pipe Tongs are the latest addition to the product line of Access Oil Tools and are manufactured at its 42,000 sq. ft. plant located in Broussard, Louisiana

Access was founded in 1985 by professionals with years of experience in oil field sales and manufacturing. We recognized the need for a reliable source of quality equipment to meet the rigorous demands of this industry. Our company has grown steadily over the years and today is a leading supplier of pipe handling equipment to the drilling industry worldwide.

- Licensed under API Spec. Q1, 7K, 8A and 8C
- ISO 9001; 2000 Certified
- All Tongs Pull Tested and Full Certification Available

In addition to the Drill Pipe Tongs detailed in this catalog, Access offers a complete range of manual and proprietary powered handling tools. Manual tools include Elevators, Slips, Safety Clamps, Spiders, Bushings, Casing Scrapers and Stabbing Guides.

The powered tools cover Kelly Spinners, Rotating Mousehole Tool, The "Twister Torque" wrenching tool and the "Twister Spin" which incorporates the Twister Torque tool and a Drill Pipe Spinner.

This detailed parts catalog can be found on the Access web page and can be downloaded in PDF file format.

Web address: www.accessoiltools.com

TORQUE RATINGS

TYPE	TORQUE RATING (ft.lbs.)	SIZE RANGE
C	35,000	2 3/8" - 10 3/4"
B	30,000	13 3/8"
	40,000	9" - 11 3/4"
	55,000	3 1/2" - 9"
B Extended Head (for Casing)	25,000	13 3/8" - 25 1/2"
HT-65	40,000	11 3/4" - 17"
	65,000	3 1/2" - 11 1/4"
HT-100	60,000	16" - 17"
	75,000	12" - 15"
	100,000	4" - 12" and 15 3/4"



AOT TYPE "B" TONG COMPLETE

AOT #	DESCRIPTION	WT.
T30114	TYPE B TONG COMPLETE W/STANDARD LEVER LESS LUG JAWS	395.00
T30114-1	TYPE B TONG COMPLETE W/SHORT LEVER LESS LUG JAWS	386.00

NOTE: ADD —ST TO END OF TONG P/N FOR TONG WITH SAFETY HANDLES & SET-BACK HANGER

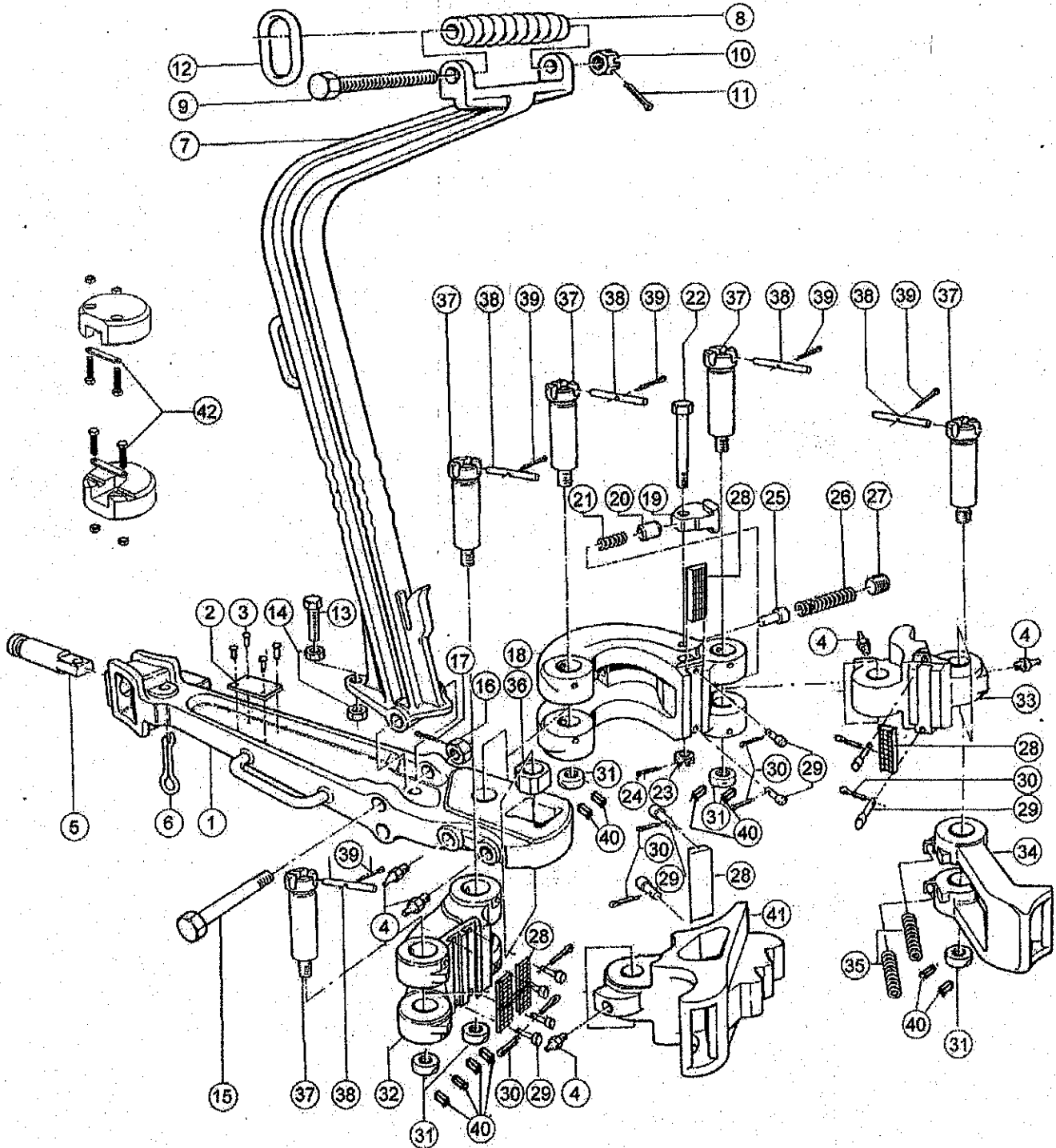

LUG JAW ASSEMBLIES FOR TYPE "B" TONG

AOT #	ITEM#	DESCRIPTION	TORQUE RATING	WT.
T11765-1	41	3 1/2 - 5 LUG JAW ASSEMBLY	55,000 ft. lbs.	30.00
T11196-3	41	4 1/4 - 6 3/4 LUG JAW ASSEMBLY	55,000 ft. lbs.	42.00
T11196-2	41	6 5/8 - 9 LUG JAW ASSEMBLY	55,000 ft. lbs.	53.00
T11297-1	41	9 - 10 3/4 LUG JAW ASSEMBLY	40,000 ft. lbs.	60.00
T13285-1	41	11 3/4 LUG JAW ASSEMBLY	40,000 ft. lbs.	61.00
T24592-3	41	12 3/4 - 13 LUG JAW ASSEMBLY	30,000 ft. lbs.	65.00
T24592-1	41	13 3/8 LUG JAW ASSEMBLY	30,000 ft. lbs.	28.00

NOTE: ADD - SH TO END OF LUG JAW P/N FOR JAWS W/SAFETY HANDLES

*Lug Jaw Assemblies include Jaw, and any required Tong Dies, Die Retainer Pins, Cotter Pins, & Grease Fittings

REPLACEMENT PARTS FOR TYPE "B" TONG

AOT #	ITEM #	DESCRIPTION	** SPARES	# REQ.	WT.
T12434-2	1-4	STANDARD LEVER ASSY. F/TYPE B TONG		1	133.00
T12434	1	STANDARD LEVER ONLY F/TYPE B TONG		1	124.00
T9568-1	1-4	SHORT LEVER ASSY. F/TYPE B TONG		1	124.00
T9568	1-4	SHORT LEVER ONLY F/TYPE B TONG		1	113.00
T2005682	2	NAME PLATE	1		.10
T53301-4-3	3	NAME PLATE SCREWS		4	.05
T53201	4	GREASE FITTING		2	.05
T9574	5	TONG LINE PIN F/TYPE B TONG	1	1	6.00
T25468	6	TONG LINE PIN RETAINER	2	1	1.00
T26782	7-14	HANGER ASSY. F/TYPE B TONG		1	56.00
T26783	7	HANGER ONLY F/TYPE B TONG		1	47.00
T26782-SH	7-14	SET BACK HANGER ASSY. F/TYPE B TONG		1	64.00
T26783-SH	7	SET BACK HANGER ONLY F/TYPE B TONG		1	55.00
T12586	8	BALANCING SCREW		1	2.75
T939099-596	9	BALANCING SCREW BOLT		1	2.10
T939484-8	10	BALANCING SCREW BOLT NUT		1	.40
T51402-14	11	COTTER PIN		1	.08
T12863	12	SUSPENSION RING		1	1.50
T939168-133	13	HANGER ADJUSTMENT SCREW		1	.75
T939248-8	14	HANGER JAM NUT		2	.25
T939097-556	15	HANGER BOLT	1	1	1.40
T940985-8	16	HANGER BOLT NUT	1	1	.25
T51402-16	17	COTTER PIN	1	1	.05
T11194-1	18-30	LONG JAW ASSY. F/TYPE B TONG		1	98.00
T11194	18	LONG JAW F/TYPE B TONG		1	95.00
T11139	19	ADJUSTABLE STOP		1	.75
T11144	20	ADJUSTABLE STOP PLUNGER		1	.15
T11192	21	ADJUSTABLE STOP SPRING		1	.15
T11191	22	ADJUSTABLE STOP BOLT		1	.55
T8150	23	ADJUSTABLE STOP BOLT NUT		1	.20
T51402-14	24	COTTER PIN		AS REQ.	.03
T11228	25	BOOSTER PLUNGER		1	.25
T11229	26	BOOSTER PLUNGER SPRING		1	.25
T940968-6	27	BOOSTER PLUNGER RETAINER PLUG		1	.25
T16402-2	28	1/2 X 1 1/4 X 5 7/8 TONG DIE	144	AS REQ.	.75
T17194	29	TONG DIE RETAINER PIN	32	AS REQ.	.03
T51402-6	30	COTTER PIN	32	AS REQ.	.01
T11142	31	HINGE PIN NUT	5	5	.35
T51506-8	40	GROOVE PIN F/HINGE PIN NUT	10	10	.05
T11197-1	32,28-30	SHORT JAW ASSY.		1	44.00
T11971	32	SHORT JAW ONLY		1	41.00
T11195-2	33, 28-30,4	LATCH JAW ASSY.		1	37.00
T11195	33	LATCH JAW ONLY		1	34.00
T11138-1	34, 31, & 40	LATCH ASSY.	1	1	28.00
T9561	35	LATCH SPRING	12	2	.10
T9572	36	LEVER HINGE PIN BLOCK	1	1	1.75
T11141	37	THREADED HINGE PIN	5	5	4.75
T11199	38	DOWELL PIN	5	5	.05
T51402-6	39	COTTER PIN	5	5	.01
T11140	NP	REMOVABLE HINGE PIN		NA	4.20
T20000-SH-2	42	SAFETY HANDLE KIT (fits all AOT tongs)	3	3	3.25

NOTE: ADD -SH TO END OF LATCH JAW ASSEMBLY, LATCH OR LATCH LUG JAWS FOR SAFETY HANDLES

**RECOMMENDED SPARE PARTS FOR 1 YEAR

