

DRILL PIPE & CASING TONGS

Drill Pipe Tongs are the latest addition to the product line of Access Oil Tools and are manufactured at its 42,000 sq. ft. plant located in Broussard, Louisiana

Access was founded in 1985 by professionals with years of experience in oil field sales and manufacturing. We recognized the need for a reliable source of quality equipment to meet the rigorous demands of this industry. Our company has grown steadily over the years and today is a leading supplier of pipe handling equipment to the drilling industry worldwide.

- Licensed under API Spec. Q1, 7K, 8A and 8C
- ISO 9001; 2000 Certified
- All Tongs Pull Tested and Full Certification Available

In addition to the Drill Pipe Tongs detailed in this catalog, Access offers a complete range of manual and proprietary powered handling tools. Manual tools include Elevators, Slips, Safety Clamps, Spiders, Bushings, Casing Scrapers and Stabbing Guides.

The powered tools cover Kelly Spinners, Rotating Mousehole Tool, The "Twister Torque" wrenching tool and the "Twister Spin" which incorporates the Twister Torque tool and a Drill Pipe Spinner.

This detailed parts catalog can be found on the Access web page and can be downloaded in PDF file format.

Web address: www.accessoiltools.com

TORQUE RATINGS

TYPE	TORQUE RATING (ft.lbs.)	SIZE RANGE
C	35,000	2 3/8" - 10 3/4"
B	30,000	13 3/8"
	40,000	9" - 11 3/4"
	55,000	3 1/2" - 9"
B Extended Head (for Casing)	25,000	13 3/8" - 25 1/2"
HT-65	40,000	11 3/4" - 17"
	65,000	3 1/2" - 11 1/4"
HT-100	60,000	16" - 17"
	75,000	12" - 15"
	100,000	4" - 12" and 15 3/4"



AOT TYPE "C" TONG COMPLETE

AOT #	DESCRIPTION	WT.
T30117-2	TYPE "C" TONG COMPLETE W/STANDARD LEVER LESS LUG JAWS (2 3/8" - 7")	250.00
T30117-3	TYPE "C" TONG COMPLETE W/SHORT LEVER LESS LUG JAWS (2 3/8" - 7")	232.00
T30117	TYPE "C" TONG COMPLETE W/STANDARD LEVER LESS LUG JAWS (7 5/8" - 10 3/4")	250.00
T30117-1	TYPE "C" TONG COMPLETE W/SHORT LEVER LESS LUG JAWS (7 5/8" - 10 3/4")	232.00

NOTE: ADD - ST TO END OF TONG P/N FOR TONG WITH SAFETY HANDLES & SET-BACK HANGER

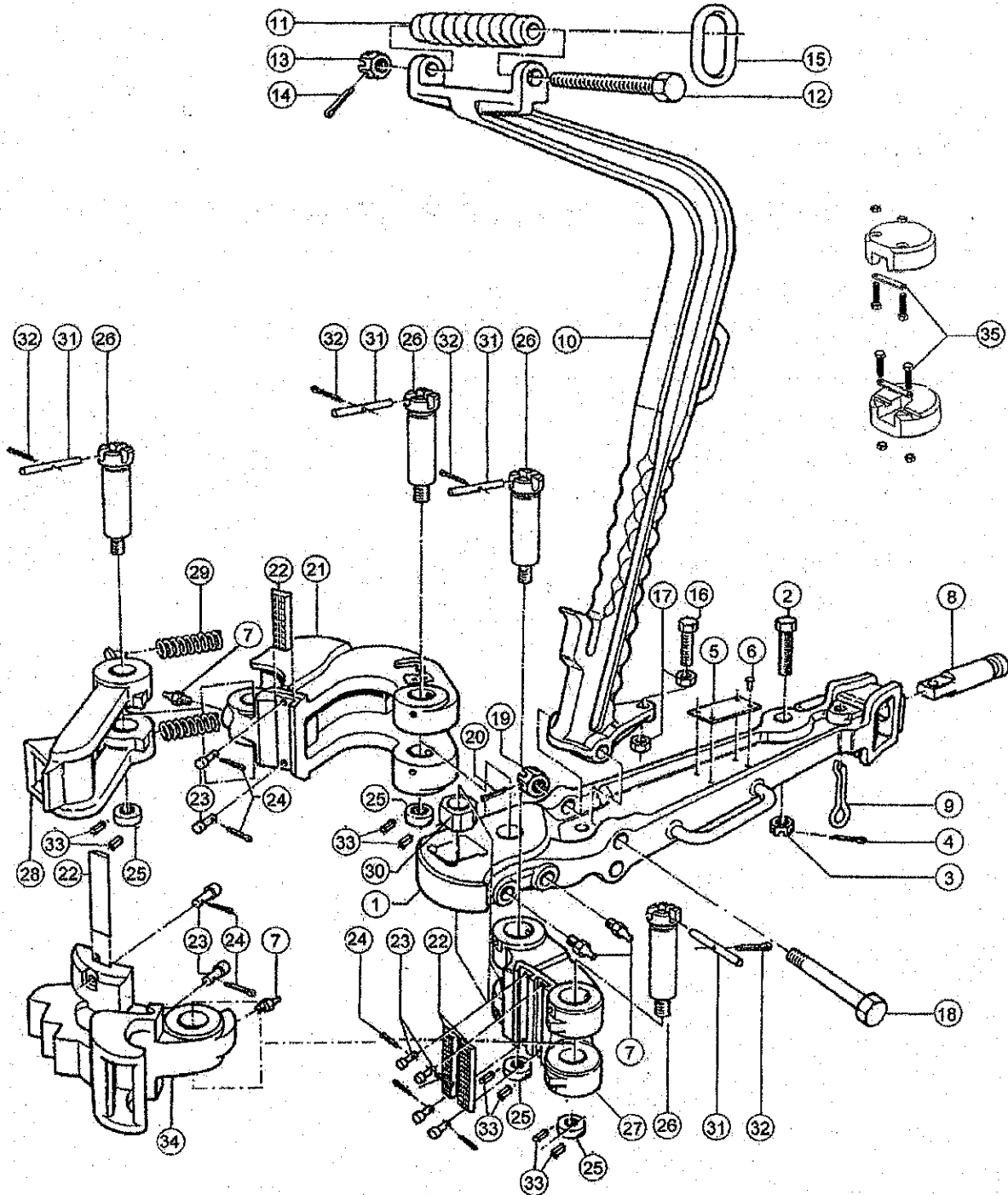

HINGE AND LUG JAW ASSEMBLIES FOR TYPE "C" TONG

AOT #	ITEM#	DESCRIPTION	TORQUE RATING	WT.
T30728-1	34	2 3/8 — 3.668 LUG JAW ASSEMBLY	35,000 ft. lbs.	33.00
T30727-1	34	2 7/8 — 4 1/4 LUG JAW ASSEMBLY	35,000 ft. lbs.	34.00
T11939-4	34	3 1/2 — 5 1/4 LUG JAW ASSEMBLY	35,000 ft. lbs.	37.00
T11940-2	34	5 1/4 — 7 LUG JAW ASSEMBLY	35,000 ft. lbs.	49.00
T11941-1	N/P	7" — 8 5/8" HINGE & LUG JAW ASSEMBLY	35,000 ft. lbs.	61.00
T11941-2	N/P	7 — 8 5/8 LUG JAW	35,000 ft. lbs.	30.00
T11942-1	N/P	7" — 8 5/8" HINGE JAW ASSEMBLY (ONLY)	35,000 ft. lbs.	28.00
T13799-1	N/P	9 5/8 — 10 3/4 HINGE & LUG JAW ASSEMBLY	35,000 ft. lbs.	76.00
T13799	N/P	9 5/8 — 10 3/4 LUG JAW	35,000 ft. lbs.	39.00
T13798-1	N/P	9 5/8 — 10 3/4 HINGE JAW ASSEMBLY (ONLY)	35,000 ft. lbs.	36.00

NOTE: ADD - SH TO END OF LUG JAW P/N FOR JAWS W/SAFETY HANDLES

*Lug Jaw Assemblies include Jaw, and any required Tong Dies, Die Retainer Pins, Cotter Pins, & Grease Fittings

REPLACEMENT PARTS FOR TYPE "C" TONG

AOT #	ITEM #	DESCRIPTION	** SPARES	# REQ.	WT.
T11516-2	1-7	STANDARD LEVER ASSY. F/TYPE C TONG		1	87.00
T11516	1	STANDARD LEVER ONLY F/TYPE C TONG		1	78.00
T11883-1	1-7	SHORT LEVER ASSY. F/TYPE C TONG		1	63.00
T11883	1	SHORT LEVER ONLY F/TYPE C TONG		1	54.00
T939099-108	2	SAFETY LINE BOLT	1	1	1.00
T50516-C	3	SAFETY LINE BOLT NUT	1	1	.25
T51402-14	4	COTTER PIN	2	1	.10
T26119-1	5	NAME PLATE		1	.10
T53301-4-3	6	NAME PLATE SCREWS		4	.05
T53201	7	GREASE FITTING		2	.05
T11517	8	TONG LINE PIN F/TYPE C TONG	1	1	4.00
T25468	9	TONG LINE PIN RETAINER	2	1	1.00
T13264-1	10-17	HANGER ASSY. F/TYPE C TONG		1	36.25
T13264	10	HANGER ONLY F/TYPE C TONG		1	25.80
T13264-1-SH	10-17	SET BACK HANGER ASSY. F/TYPE C TONG		1	44.00
T13264-SH	10	SET BACK HANGER ONLY F/TYPE C TONG		1	33.55
T12586	11	BALANCING SCREW		1	2.75
T939099-596	12	BALANCING SCREW BOLT		1	2.10
T939484-8	13	BALANCING SCREW BOLT NUT		1	.40
T51402-10	14	COTTER PIN		1	.08
T12863	15	SUSPENSION RING		1	1.50
T939168-133	16	HANGER ADJUSTMENT SCREW		1	.75
T939248-8	17	HANGER JAM NUT	2		.25
T30329	18-20	HANGER BOLT ASSY.	1	1	1.50
T939097-516	18	HANGER BOLT		1	1.40
T940985-8	19	HANGER BOLT NUT		1	.25
T51402-10	20	COTTER PIN		1	.05
T11511-1	21-24.7	LONG JAW ASSY. F/TYPE C TONG		1	64.00
T11511	21	LONG JAW F/TYPE C TONG		1	63.00
T16401-2	22	1/2 X 1 1/4 X 5 TONG DIE	144	AS REQ.	.55
T17194	23	TONG DIE RETAINER PIN	24	AS REQ.	.03
T51402-6	24	COTTER PIN	36	AS REQ.	.01
T11522	25	HINGE PIN NUT	4	4	.35
T51506-8	33	GROOVE PIN F/HINGE PIN NUT	8	8	.05
T11521-1	26	THREADED HINGE PIN	4	4	2.65
T11513-5	27, 22-24	SHORT JAW ASSY. (2 3/8 — 7)		1	31.75
T11513-1	27, 22-24	SHORT JAW ASSY. (7 5/8 — 10 3/4)		1	31.75
T11933-1	28, 25, & 33	LATCH ASSY.	1	1	17.25
T9561	29	LATCH SPRING	12	2	.10
T11523	30	LEVER HINGE PIN BLOCK	1	3	2.65
T11199	31	DOWELL PIN	4	4	.05
T51402-6	32	COTTER PIN	4	4	.01
T11520-1	NP	REMOVABLE HINGE PIN	NA		2.75
T20000-SH-2	35	SAFETY HANDLE KIT (fits all AOT tongs)	3	3	3.25

NOTE: ADD -SH TO END OF LONG JAW, LATCH JAW, OR LATCH LUG JAWS FOR SAFETY HANDLES

**RECOMMENDED SPARE PARTS FOR 1 YEAR

